

SCALE: 25 Rods per inch.

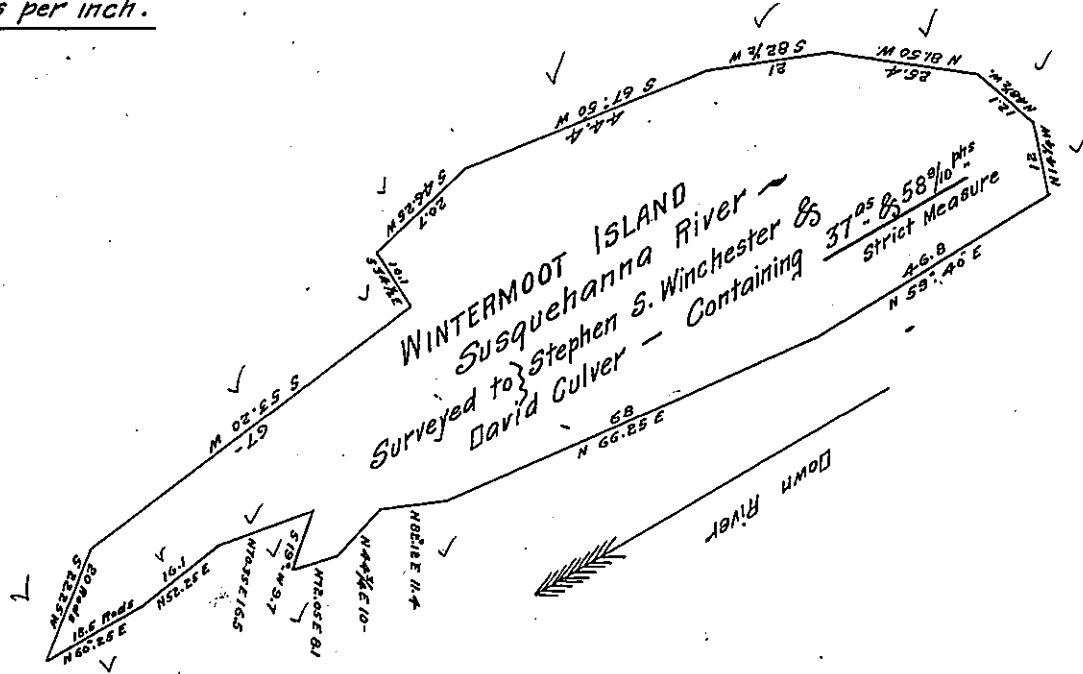

Draft of Wintermoot Island Located in the Susquehanna River and said to be in Exeter Township Luzerne County. Bounded on the Surrounding Shores by Lands of Schooley & M<sup>c</sup>Farland George Lazerus and the Pennsylvania Coal C<sup>o</sup> the above mentioned was Surveyed to Low Water Mark and Contains Thirty Seven Acres and Fifty Eight and nine tenth perches (37.58<sup>10</sup>/<sub>10</sub> perches) Strict Measure.

Surveyed the above Island to Stephen S. Winchester and David Culver, in pursuance of their Warrant dated Oct. 4<sup>th</sup> A. D. One thousand Eight Hundred and Seventy (1870) - Surveyed Oct. 8<sup>th</sup> (1870) one thousand eight hundred and Seventy.

Patrick Blewitt

C<sup>o</sup> Surveyor.

For Value received I do hereby assign, transfer and set over unto Stephen S. Winchester his heirs and assigns, all my right title and interest claim and demand in and to "Wintermoot Island" described in the foregoing and annexed Draft, and order and direct that a Patent be issued to him for the same.

Witness my hand and seal this 14<sup>th</sup> day of October A. D. 1870.

Witness:  
James Space.

David Culver.



IN TESTIMONY that the above is a copy of the original remaining on file in the Department of Internal Affairs of Pennsylvania, made conformably to an Act of Assembly approved the 16th day of February, 1833, I have hereunto set my Hand and caused the Seal of said Department to be affixed at Harrisburg, this

eleventh day of June 1908

Nancy Howard  
Secretary of Internal Affairs.